

PARKING SCHEDULE

8.5' X 17' - 90 DEGREES	23
9' X 17' - 90 DEGREES	618
9' X 17.5' - 90 DEGREES	43
HANDICAPPED	17
PARALLEL	8
Grand total	709

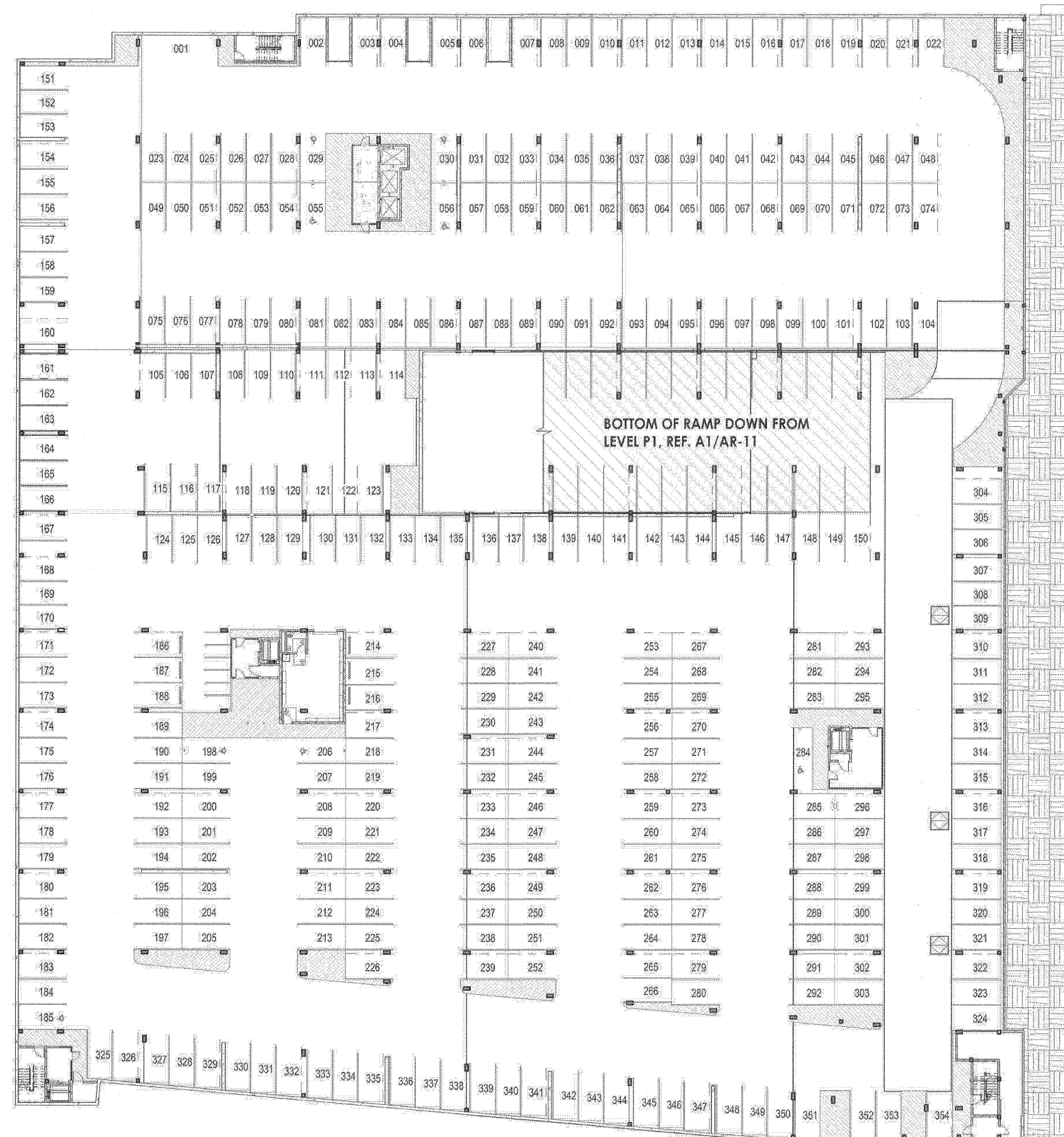

C1 PARKING - LEVEL P2
1" = 30'-0"

P2 PARKING TOTAL: 354

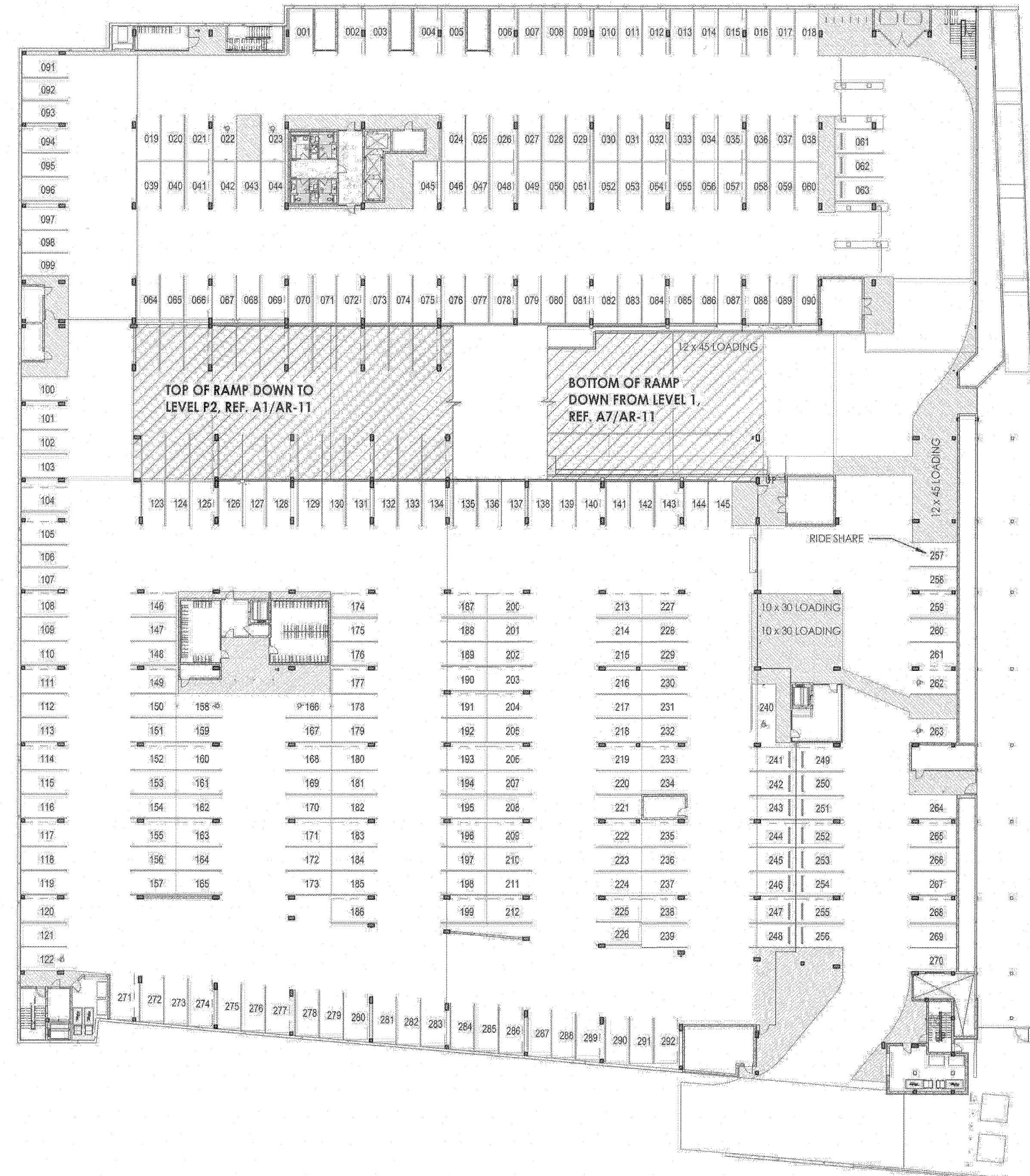

C9 PARKING - LEVEL P1
1" = 30'-0"

P1 PARKING TOTAL: 292

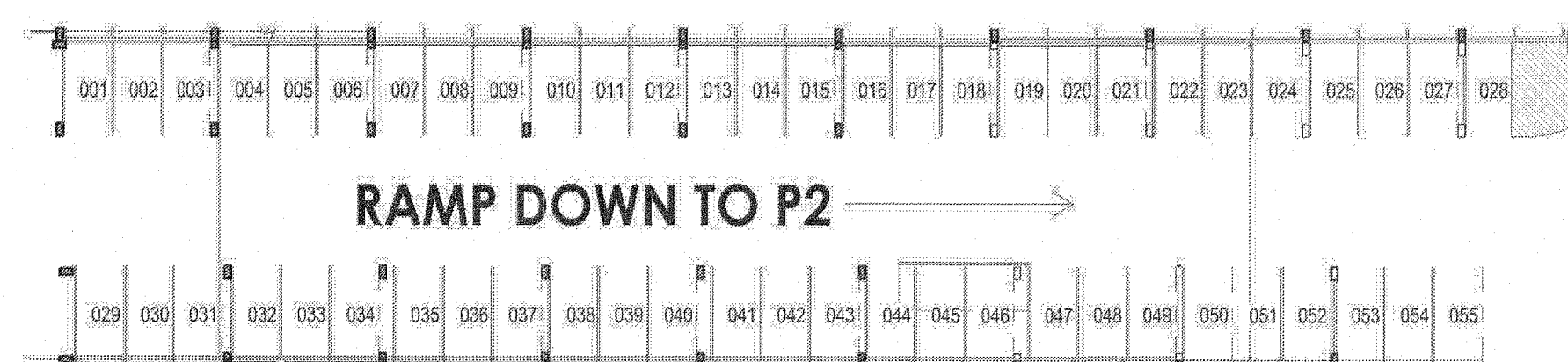

A1 RAMP - LEVEL P1 TO LEVEL P2
1" = 30'-0"

RAMP PARKING TOTAL: 55

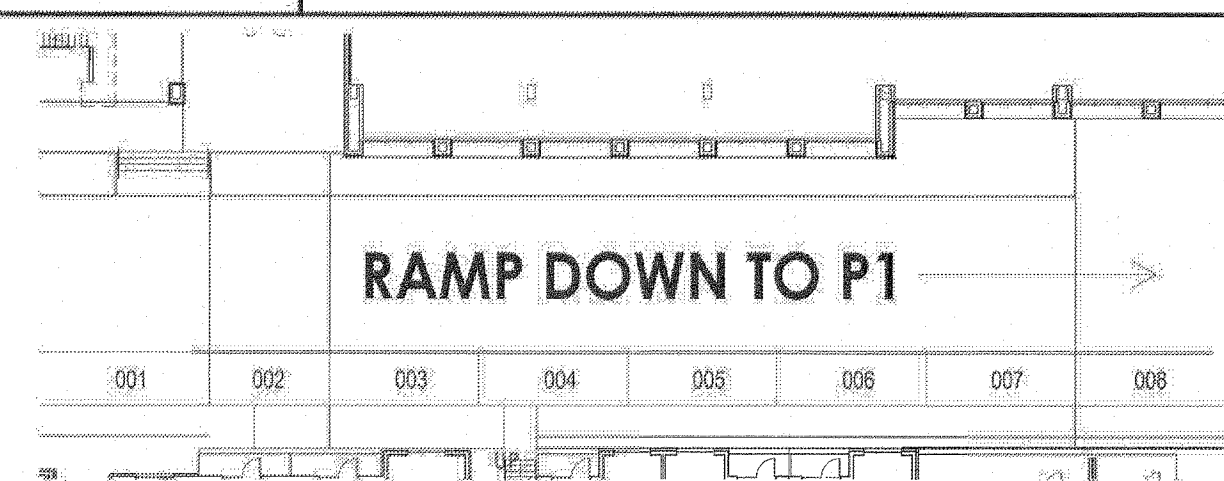

A7 RAMP - LEVEL 1 TO LEVEL P1
1" = 30'-0"

RAMP PARKING TOTAL: 8



SITE PLAN RELEASE	
FILE NUMBER: SP-2020-0169C	EXPIRATION DATE: 04/17/2020
CASE MANAGER: RANDY ROLDA	APPLICATION DATE: 04/17/2020
APPROVED ADMINISTRATIVELY ON:	
APPROVED BY PLANNING COMMISSION ON:	
APPROVED BY CITY COUNCIL ON:	
under Section 112 of Chapter 25-5 of the Austin City Code.	
Director for Development Services Department	CS-MU-V-CO, CS-V,
DATE OF RELEASE:	Zoning: CS-CO & CS-VO-CO
Rev. No. 1	Correction No.1
Rev. No. 2	Correction No.2
Rev. No. 3	

RELEASE OF THIS APPLICATION DOES NOT CONSTITUTE A VERIFICATION OF ALL DATA. INFORMATION AND CALCULATIONS SUPPLIED BY THE APPLICANT. THE ENGINEER OF RECORD IS SOLELY RESPONSIBLE FOR THE COMPLETENESS, ACCURACY AND ADEQUACY OF HIS/HER SUBMITTAL, WHETHER OF NOT THE APPLICATION IS REVIEWED FOR CODE COMPLIANCE BY CITY ENGINEERS.



www.stgdesign.com
© STG DESIGN, INC. ALL RIGHTS RESERVED

STG Design, Inc.
828 West 6th Street
Suite 300
Austin, TX 78703
512.899.3500

1401 SOUTH LAMAR
MULTIFAMILY AND
GARAGE
AUSTIN, TEXAS 78704

These documents may not be reproduced in any form without the written consent of STG Design, Inc.

This sheet is only one component of the total document package which consists of all sheets of drawings and the project manual.

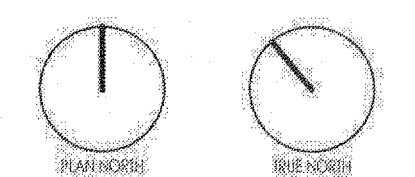

Issues
Project Number: 14.18836.00
Project Director: JT
Quality Assurance: Checker
Drawn By: NP

PARKING COUNT

AR 11

56
OF 58

SP-2020-0169C